

BPF Series

Button Plugs with Flush-Type Heads

BPF Series button plugs with flush-type heads can be used for plugging holes in equipment made of sheet metal, such as automobile bodies, tanks, refrigeration units, etc.

- Easily snap into place
- Held in place by a bead until deliberately removed

Material: Low-Density Polyethylene **Color:** Black

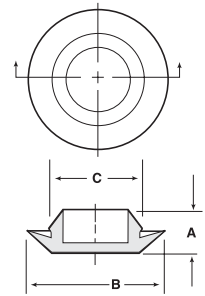

Button Plugs with Flush-Type Heads BPF Series

** Material is EVA (ethylene vinyl acetate).

Caplugs No.	Dimensions										Packaging	
	Hole Size		Metal Thickness		A		B		C		Carton Quantity	Mini Pak Quantity
	In	mm	In	mm	In	mm	In	mm	In	mm		
BPF-5mm**	.18 - .19	4.57 - 4.90	.02 - .04	.51 - 1.02	.21	5.40	.39	9.90	.21	5.40	5000	1000
BPF-6mm**	.23 - .24	5.84 - 6.10	.02 - .06	.51 - 1.52	.45	11.40	.50	12.70	.29	7.40	5000	1000
BPF-1/4**	.24 - .25	6.10 - 6.35	.02 - .07	.51 - 1.78	.21	5.33	.50	12.70	.28	7.11	5000	1000
BPF-1/4-4**	.24 - .25	6.10 - 6.35	.07 - .13	1.78 - 3.30	.30	7.62	.50	12.70	.28	7.11	5000	1000
BPF-11/32**	.34 - .35	8.64 - 8.89	.04 - .06	1.02 - 1.52	.23	5.84	.55	13.97	.37	9.40	10000	2000
BPF-3/8	.37 - .38	9.40 - 9.65	.02 - .05	.51 - 1.27	.19	4.83	.75	19.05	.41	10.41	5000	1000
BPF-3/8-3	.37 - .38	9.40 - 9.65	.06 - .11	1.52 - 2.79	.24	6.10	.75	19.05	.41	10.41	5000	1000
BPF-7/16	.43 - .45	10.92 - 11.43	.03 - .06	.76 - 1.52	.22	5.59	.69	17.53	.47	11.94	5000	1000
BPF-1/2	.49 - .51	12.45 - 12.95	.03 - .08	.76 - 2.03	.25	6.35	.86	21.84	.54	13.72	5000	1000
BPF-9/16	.55 - .56	13.97 - 14.22	.03 - .08	.76 - 2.03	.25	6.35	.86	21.84	.59	15.06	5000	1000
BPF-5/8	.61 - .63	15.49 - 16.00	.06 - .08	1.52 - 2.03	.26	6.60	.81	20.57	.67	17.02	5000	1000
BPF-SI-430	.62	15.87	.06 - .08	1.52 - 2.03	.25	6.35	1.06	26.92	.68	17.15	10000	2000
BPF-11/16	.68 - .70	17.27 - 17.78	.03 - .08	.76 - 2.03	.25	6.35	1.01	25.66	.73	18.54	5000	1000
BPF-3/4	.73 - .76	18.54 - 19.30	.05 - .11	1.27 - 2.79	.29	7.37	1.01	25.66	.79	20.07	5000	1000
BPF-13/16-6	.80 - .83	20.32 - 21.08	.16 - .19	4.06 - 4.83	.37	9.40	1.11	28.20	.85	21.59	5000	1000
BPF-SI-402	.81	20.62	.16 - .19	.76 - 2.03	.37	9.40	1.11	28.19	.85	21.59	6000	1200
BPF-7/8	.86 - .88	21.84 - 22.35	.03 - .08	.76 - 2.03	.25	6.35	1.16	29.47	.91	23.11	5000	1000
BPF-7/8-6	.86 - .88	21.84 - 22.35	.13 - .18	3.30 - 4.57	.36	9.14	1.16	29.47	.91	23.11	5000	1000
BPF-15/16	.92 - .95	23.37 - 24.13	.03 - .08	.76 - 2.03	.25	6.35	1.31	33.28	.98	24.89	5000	1000
BPF-SI-413	1.00	25.40	.03 - .08	.76 - 2.03	.25	6.35	1.38	35.05	1.04	26.42	5000	1000
BPF-SI-465	1.09	27.60	.03 - .08	.76 - 2.03	.25	6.35	1.31	33.27	1.15	29.21	5000	1000
BPF-1-5	.98 - 1.01	24.89 - 25.66	.08 - .20	2.03 - 5.08	.40	10.16	1.35	34.29	1.04	26.42	2500	500
BPF-SI-404	1.125	28.58	.03 - .08	.76 - 2.03	.43	10.92	1.53	38.86	1.18	29.97	2000	400
BPF-1-1/8-6	1.10 - 1.15	27.94 - 29.21	.02 - .18	.51 - 4.57	.43	10.92	1.53	38.86	1.18	29.97	2500	500
BPF-1-3/16	1.16 - 1.20	29.47 - 30.48	.03 - .08	.76 - 2.03	.25	6.35	1.56	39.63	1.22	30.99	2500	500
BPF-SI-414	1.25	31.75	.03 - .08	.76 - 2.03	.25	6.35	1.62	41.15	1.29	32.77	2500	500
BPF-1-5/16	1.29 - 1.33	32.77 - 33.78	.03 - .08	.76 - 2.03	.25	6.35	1.68	42.67	1.36	34.55	2500	500
BPF-SI-415	1.50	38.10	.03 - .08	.76 - 2.03	.25	6.35	1.88	47.75	1.54	39.12	2000	500
BPF-SI-416	1.75	44.45	.03 - .08	.76 - 2.03	.25	6.35	2.12	53.85	1.79	45.47	1500	400
BPF-2	1.98 - 2.01	50.29 - 51.05	.03 - .08	.76 - 2.03	.29	7.36	2.36	59.94	2.04	51.81	1000	200
BPF-2-1/8	2.10 - 2.14	53.34 - 54.36	.03 - .08	.76 - 2.03	.25	6.35	2.49	63.25	2.17	55.12	1000	200
BPF-SI-419	2.50	63.50	.03 - .08	.76 - 2.03	.25	6.35	3.00	76.20	2.56	65.02	1000	200
BPF-SI-472	2.62	66.67	.03 - .08	.76 - 2.03	.25	6.35	3.12	79.25	2.68	67.95	1000	200
BPF-3	2.97 - 3.02	75.44 - 76.71	.03 - .08	.76 - 2.03	.25	6.35	3.36	85.35	3.06	77.73	750	150
BPF-SI-407	3.12	79.37	.03 - .08	.76 - 2.03	.25	6.35	3.52	89.41	3.18	80.77	700	140
BPF-3-3/8	3.35 - 3.40	85.09 - 86.36	.03 - .08	.76 - 2.03	.28	7.11	3.75	95.25	3.43	87.13	500	100
BPF-3-1/2	3.47 - 3.52	88.14 - 89.41	.03 - .11	.76 - 2.79	.35	8.89	3.86	98.05	3.56	90.43	500	100
BPF-4	3.97 - 4.02	100.84 - 102.11	.05 - .10	1.27 - 2.54	.28	7.11	4.37	111.00	4.13	104.91	500	100
BPF-SI-425	4.00	101.60	.05 - .10	1.27 - 2.54	.29	7.37	4.50	114.30	4.06	103.12	350	70
BPF-SI-425S	4.00	101.60	.05 - .10	1.27 - 2.54	.50	12.70	4.50	114.30	4.10	104.14	400	80
BPF-4-3/4	4.75	120.67	.05 - .10	1.27 - 2.54	.31	7.87	5.17	131.32	4.81	122.17	400	80