

BP Series

Button Plugs with Recessed-Type Heads

BP Series button plugs with recessed type heads can be used for plugging holes in equipment made of sheet metal, such as auto bodies, tanks, refrigeration units, etc.

- Easily snap into place
- Held in place by a bead until deliberately removed

Material: Low-Density Polyethylene **Color:** Black

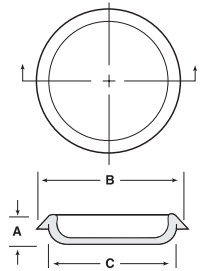

Button Plugs with Recessed-Type Heads BP Series

Caplugs No.	Dimensions										Packaging	
	Hole Size		Metal Thickness		A		B		C		Carton Quantity	Mini Pak Quantity
	In	mm	In	mm	In	mm	In	mm	In	mm		
BP-3/8	.37 - .39	9.40 - 9.91	.02 - .10	.51 - 2.54	.31	7.87	.75	19.05	.41	10.41	5000	1000
BP-1/2	.50 - .52	12.70 - 13.208	.02 - .07	.51 - 1.78	.29	7.37	.85	21.59	.55	13.97	5000	1000
BP-1/2-4	.50 - .52	12.70 - 13.208	.06 - .13	1.52 - 3.30	.32	8.13	.85	21.59	.55	13.97	5000	1000
BP-11/16	.68 - .70	17.27 - 17.78	.02 - .09	.51 - 2.29	.28	7.11	1.04	26.42	.73	18.54	5000	1000
BP-3/4	.73 - .76	18.542 - 19.304	.02 - .14	.51 - 3.56	.34	8.64	1.16	29.46	.79	20.07	5000	1000
BP-13/16	.79 - .82	20.07 - 20.83	.02 - .07	.51 - 1.78	.29	7.37	1.15	29.21	.85	21.59	5000	1000
BP-7/8	.87 - .90	22.10 - 22.86	.02 - .10	.51 - 2.54	.35	8.89	1.23	31.24	.93	23.62	5000	1000
BP-29/32	.90 - .91	22.86 - 23.11	.02 - .10	.51 - 2.54	.35	8.89	1.25	31.75	.95	24.13	5000	1000
BP-1	.99 - 1.02	25.15 - 25.91	.02 - .10	.51 - 2.54	.35	8.89	1.35	34.29	1.05	26.67	5000	1000
BP-1-1/16	1.04 - 1.07	26.42 - 27.18	.02 - .10	.51 - 2.54	.35	8.89	1.40	35.56	1.10	27.94	5000	1000
BP-1-3/32	1.09 - 1.12	27.69 - 28.45	.02 - .10	.51 - 2.54	.35	8.89	1.47	37.34	1.16	29.46	5000	1000
BP-1-1/8	1.10 - 1.15	27.94 - 29.21	.02 - .18	.51 - 4.57	.43	10.92	1.53	38.86	1.18	29.97	2500	500
BP-1-1/4	1.23 - 1.27	31.24 - 32.26	.01 - .10	.25 - 2.54	.35	8.89	1.60	40.64	1.30	33.02	2500	500
BP-1-5/16	1.30 - 1.34	33.02 - 34.04	.01 - .10	.25 - 2.54	.35	8.89	1.67	42.42	1.36	34.54	2500	500
BP-1-3/8	1.36 - 1.40	34.55 - 35.56	.02 - .10	.25 - 2.54	.35	8.89	1.73	43.94	1.43	36.32	2500	500
BP-1-1/2	1.48 - 1.52	37.59 - 38.61	.02 - .10	.25 - 2.54	.35	8.89	1.85	46.99	1.55	39.37	2500	500
BP-1-1/2-7	1.48 - 1.52	37.59 - 38.61	.13 - .22	3.30 - 5.59	.50	12.70	1.83	46.48	1.54	39.12	2000	400
BP-SI 416-2	1.75	44.45	.02 - .10	.51 - 2.54	.35	8.89	2.13	54.10	1.80	45.72	1500	300
BP-1-5/8	1.59 - 1.65	40.39 - 41.91	.03 - .10	.76 - 2.54	.36	9.14	2.00	50.80	1.68	42.67	1500	300
BP-1-3/4-5	1.70 - 1.78	43.18 - 45.21	.02 - .16	.51 - 4.06	.43	10.92	2.25	57.15	1.80	45.72	2000	400
BP-1-13/16	1.77 - 1.82	44.96 - 46.23	.02 - .10	.51 - 2.54	.35	8.89	2.16	54.86	1.85	46.99	2500	500
BP-1-7/8	1.85 - 1.90	46.99 - 48.26	.02 - .10	.51 - 2.54	.35	8.89	2.24	56.90	1.93	49.02	2000	400
BP-2	1.97 - 2.02	50.04 - 51.31	.02 - .10	.51 - 2.54	.36	9.14	2.35	59.69	2.05	52.07	1000	200
BP-2-1/2-5	2.44 - 2.53	61.98 - 64.26	.02 - .14	.51 - 3.56	.43	10.92	3.00	76.20	2.55	64.77	1000	200
BP-SI 419-2	2.50	64.50	.02 - .10	.51 - 2.54	.38	9.65	3.00	76.20	2.55	64.77	1250	250
BP-SI 421-2	3.00	76.20	.02 - .10	.51 - 2.54	.41	10.41	3.56	90.42	3.06	77.72	500	100