

EC Series Caps for Threaded Connectors



Made to protect threaded connectors, EC Series caps are designed for easy application and removal in areas not readily accessible. They can be installed over threads or cylindrical surfaces.

- Can be installed over threads or cylindrical surfaces
- Applicable specifications: NAS 813, NAS 831

Material: Low-Density Polyethylene **Color:** Red

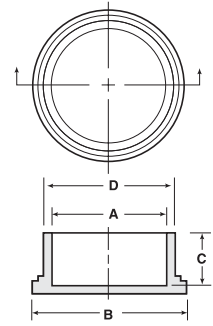

Caps for Threaded Connectors EC Series

| Caplugs No. | To Cap Nominal Thread Size | Dimensions | | | | | | | | Packaging | |
|-------------|----------------------------|------------|--------|------|--------|------|-------|------|--------|-----------------|-------------------|
| | | A | | B | | C | | D | | Carton Quantity | Mini Pak Quantity |
| | | In | mm | In | mm | In | mm | In | mm | | |
| EC-4 | 1/4 | .246 | 6.25 | .48 | 12.19 | .50 | 12.70 | .31 | 7.87 | 5000 | 1000 |
| EC-M8 | M8 | .309 | 7.85 | .55 | 13.97 | .56 | 14.22 | .37 | 9.40 | 5000 | 1000 |
| EC-5 | 5/16 | .308 | 7.82 | .55 | 13.97 | .56 | 14.22 | .37 | 9.40 | 5000 | 1000 |
| EC-6 | 3/8 | .369 | 9.37 | .62 | 15.75 | .50 | 12.70 | .43 | 10.92 | 5000 | 1000 |
| EC-8 | 1/2 | .480 | 12.19 | .74 | 18.80 | .50 | 12.70 | .54 | 13.72 | 5000 | 1000 |
| EC-9 | 9/16 | .551 | 14.00 | .78 | 19.81 | .44 | 11.18 | .61 | 15.49 | 5000 | 1000 |
| EC-10 | 5/8 | .605 | 15.37 | .84 | 21.34 | .50 | 12.70 | .66 | 16.89 | 5000 | 1000 |
| EC-12 | 3/4 | .720 | 18.29 | .97 | 24.64 | .50 | 12.70 | .77 | 19.68 | 5000 | 1000 |
| EC-14 | 7/8 | .850 | 20.83 | 1.13 | 28.70 | .50 | 12.70 | .90 | 22.99 | 5000 | 1000 |
| EC-15 | - | .930 | 23.62 | 1.20 | 30.47 | .50 | 12.70 | 1.01 | 25.65 | 3000 | 600 |
| EC-16 | 1 | .973 | 24.71 | 1.22 | 30.99 | .50 | 12.70 | 1.03 | 26.29 | 2500 | 500 |
| EC-18 | 1-1/8 | 1.093 | 27.76 | 1.33 | 33.78 | .56 | 14.22 | 1.15 | 29.35 | 2500 | 500 |
| EC-19 | 1-3/16 | 1.188 | 30.18 | 1.40 | 35.56 | .56 | 14.22 | 1.23 | 31.24 | 2500 | 500 |
| EC-20 | 1-1/4 | 1.231 | 31.27 | 1.47 | 37.09 | .56 | 14.22 | 1.30 | 33.05 | 2500 | 500 |
| EC-22 | 1-3/8 | 1.340 | 34.04 | 1.59 | 40.39 | .56 | 14.22 | 1.41 | 35.81 | 2500 | 500 |
| EC-23 | 1-7/16 | 1.428 | 36.27 | 1.65 | 41.91 | .56 | 14.22 | 1.46 | 37.08 | 1000 | 200 |
| EC-24 | 1-1/2 | 1.463 | 37.16 | 1.70 | 43.18 | .56 | 14.22 | 1.53 | 38.94 | 2500 | 500 |
| EC-25 | 1-9/16 | 1.528 | 38.81 | 1.73 | 43.94 | .48 | 12.19 | 1.59 | 40.39 | 2500 | 500 |
| EC-26 | 1-5/8 | 1.613 | 40.97 | 1.91 | 48.51 | .55 | 19.97 | 1.71 | 43.43 | 1000 | 200 |
| EC-28 | 1-3/4 | 1.715 | 43.56 | 1.95 | 49.53 | .56 | 14.22 | 1.79 | 45.47 | 1000 | 200 |
| EC-32 | 2 | 1.965 | 49.91 | 2.22 | 56.39 | .56 | 14.22 | 2.04 | 51.82 | 1000 | 200 |
| EC-36 | 2-1/4 | 2.215 | 56.26 | 2.43 | 61.72 | .60 | 15.24 | 2.29 | 58.17 | 1000 | 200 |
| EC-40 | 2-1/2 | 2.456 | 62.38 | 2.68 | 68.07 | .62 | 15.75 | 2.52 | 64.01 | 1000 | 200 |
| EC-44 | 2-3/4 | 2.720 | 69.09 | 2.96 | 68.32 | .60 | 15.24 | 2.81 | 71.42 | 500 | 100 |
| EC-48 | 3 | 2.960 | 75.18 | 3.23 | 82.05 | .60 | 15.24 | 3.05 | 77.47 | 500 | 100 |
| EC-64 | 4 | 3.940 | 100.08 | 4.16 | 105.67 | 1.00 | 25.40 | 4.00 | 101.60 | 200 | 40 |
| EC-80 | 5 | 4.944 | 125.58 | 5.12 | 130.05 | 1.25 | 31.75 | 5.00 | 127.00 | 150 | 30 |