

RER Series

Plugs for Rectangular Tubing

RER Series plugs for rectangular tubing feature a series of externally tapered ribs designed to provide a sure grip inside a tube without unattractive plastic shavings. Durable construction ensures exceptional performance in business and commercial applications.

- Broad selection of width to length proportions

Material: Low-Density Polyethylene **Color:** Black

RER (50x100mm) 6-12 available in white.

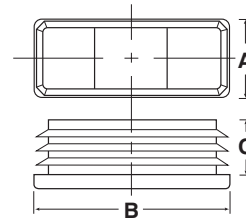

† Plain shank

Plugs for Rectangular Tubing RER Series

Caplugs No.	Dimensions					Packaging	
	A	B	Gauge (Wall Thickness) In	C		Carton Quantity	Mini Pak Quantity
	In	In		In	mm		
RER-1/2x1-16-18	.500	1.000	16 - 18 Ga. (.065 - .049)	.43	10.92	2500	500
RER-RC-0515	.500	1.500	14 - 20 Ga. (.083 - .035)	.50	12.70	3000	600
RER-5/8x1 1/8-14-20	.625	1.125	14 - 20 Ga. (.083 - .035)	.43	10.92	2000	400
REC-5/8x1-1/4-14	.625	1.250	14 Ga. (.083)	.50	12.70	2000	400
RER-5/8x1-3/8-14-20	.625	1.375	14 - 20 Ga. (.083 - .035)	.43	10.92	2500	500
RER-3/4x1-1/2-14-20	.750	1.500	14 - 20 Ga. (.083 - .035)	.43	10.92	2000	400
RER-1x1-1/4-14-20	1.000	1.250	14 - 20 Ga. (.083 - .035)	.50	12.70	2000	400
RER-1x1-1/2-10-14	1.000	1.500	10 - 14 Ga. (.134 - .083)	.50	12.70	1000	200
RER-1x1-1/2-14-20	1.000	1.500	14 - 20 Ga. (.083 - .035)	.50	12.70	1000	200
RER-1x2-10-14	1.000	2.000	10 - 14 Ga. (.134 - .083)	.50	12.70	1000	200
RER-1x2-14-20	1.000	2.000	14 - 20 Ga. (.083 - .035)	.50	12.70	1000	200
RER-RC-1020-3†	1.000	2.000	18 Ga. (.049)	.36	9.14	1500	300
RER-RC-1025	1.000	2.500	14 - 20 Ga. (.083 - .035)	.45	11.43	1000	200
RER-1x2-1/2-16-18	1.000	2.500	16 - 18 Ga. (.065 - .049)	.50	12.70	1000	200
RER-1x3-14-20	1.000	3.000	14 - 20 Ga. (.083 - .035)	.51	12.95	500	100
RER-1-1/2x2-10-14	1.500	2.000	10 - 14 Ga. (.134 - .083)	.50	12.70	600	120
RER-1-1/2x2-1/2-12-16	1.500	2.500	12 - 16 Ga. (.109 - .065)	.53	13.46	300	60
RER-RC-1530-1	1.500	3.000	10 - 14 Ga. (.134 - .083)	.50	12.70	500	100
RER-1-1/2x3-1/2-10-14	1.500	3.500	10 - 14 Ga. (.134 - .083)	.60	15.24	300	60
RER-2x2-1/2-10-14	2.000	2.500	10 - 14 Ga. (.134 - .083)	.52	13.20	500	100
RER-2x3-6-8	2.000	3.000	6 - 8 Ga. (.203 - .165)	.52	31.20	250	50
RER-2x3-10-14	2.000	3.000	10 - 14 Ga. (.134 - .083)	.52	13.21	250	50
RER-RC-2030	2.000	3.000	14 - 20 Ga. (.083 - .035)	.50	12.70	500	100
RER-RC-2040-2	2.000	4.000	6 - 11 Ga. (.203 - .120)	.94	23.88	350	70
RER-40x80-3-4mm	40mm	80mm	3 - 4mm	.94	23.88	250	50
<i>RER-50x100mm 6-12</i>	2.000	4.000	6 - 8 Ga. (.203 - .109)	.65	16.51	200	40
RER-RC-2040-1	2.000	4.000	10 - 14 Ga. (.134 - .083)	.50	12.70	250	50
RER-RC-2040	2.000	4.000	14 - 20 Ga. (.083 - .035)	.50	12.70	250	50
RER-RC-2050-3†	2.000	5.000	8 Ga. (.165)	1.00	25.40	200	40
RER-RC-2050-4†	2.000	5.000	10 Ga. (.134)	1.00	25.40	175	35
RER-2x5-10-14	2.000	5.000	10 - 14 Ga. (.134 - .083)	.75	19.05	250	50
RER-3x4-6-8	3.000	4.000	6 - 8 Ga. (.203 - .165)	.98	24.90	100	20