

# RPO-M Series

## Threaded Plugs



RPO-M Series plugs provide dual seals on ISO fluid power system metric ports. An integral O-ring-type bead seals snugly into the bevel of the threaded opening to prevent oil or fluid leakage. A 12-point head makes it possible to tighten with socket or wrench.

- SAE threaded ports
- Easy to install or remove
- Molded O-ring

**Material:** Polypropylene **Color:** Green

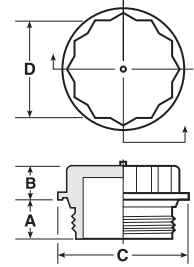

\* RPO-M12Sx1.5 is Blue, RPO-M13x1.5 is Black.

## Threaded Plugs RPO-M Series

Caplugs No.	To Plug Thread Size - Inches	Dimensions						Packaging		
		A		B		C		12-Point Socket Size D	Carton Quantity	Mini Pak Quantity
		In	mm	In	mm	In	mm			
RPO-M10x1.5	10 x 1.5	.33	8.51	.33	8.41	.65	16.51	12	5000	1000
RPO-M12x1.5	12 x 1.5	.41	10.41	.34	8.64	.73	18.54	10	5000	1000
RPO-M12Sx1.5*	12 x 1.5	.34	8.50	.33	8.40	.73	18.50	10	5000	1000
RPO-M13x1.5*	13 x 1.5	.34	8.50	.37	9.30	.73	18.50	12	5000	1000
RPO-M14x1.5	14 x 1.5	.41	10.41	.38	9.65	.81	20.57	12	5000	1000
RPO-M18x1.5	18 x 1.5	.41	10.41	.44	11.18	.97	24.64	16	3000	600
RPO-M22x1.5	22 x 1.5	.41	10.41	.44	11.18	1.12	28.45	20	2000	400
RPO-M27x2	27 x 2	.41	10.41	.44	11.18	1.36	34.54	24	2000	400